

# SWING GATES

## GATE-TS

Gate-TS is electric gate opener with a metal U-shape flag. It has fixed passage width. The shape and design of wing flag can be customized.



ELEGANCE, LIGHTNESS AND SIMPLICITY MAKE THE SERVO-TYPE SWING GATE  
INDISPENSABLE AS A PART OF ACCESS CONTROL SYSTEM

 **650/900**  
mm  
PASSAGE WIDTH

 **IP 41-65\***  
PROTECTIVE LEVEL

 **PASSAGE FOR DISABLED**

 **MOTORIZED**

 **BI-DIRECTIONAL**

### Advantages

- Solution for disabled and trolley access
- Appropriate addition to other TiSO turnstiles (waist-height and full-height)
- Steadfast housing suitable for high traffic areas
- Can be integrated with any type of access control systems
- Low power consumption
- Left hand, right hand and double-sided opening are available
- Low noise system operation
- Gate housing could be adapted for both indoor and outdoor installations
- Can be mounted on a mobile platform (TiSO Frame-M)
- Fail safe

### Standard

- Wired remote control panel

### Options

- Connection to additional external stand with integrated passes counter/RFID device/coin acceptor push button/fingerprint/barcode/QR-code reader etc.)
- Radio controller
- Heating function for external installation
- Automatic opening when power goes off
- Passage width may vary upon client's request

\* first figure is standard, all other available upon request.



www.tiso.global  
+380 (44) 291-21-11  
e-mail: sales@tiso.global



## Technical Specifications:

|                              |           |
|------------------------------|-----------|
| Passage width, mm            | 650/900   |
| Unit width, mm               | 815/1065  |
| Unit diameter, mm            | 225       |
| Unit height (with glass), mm | 1000      |
| Unit weight, kg (not more)   | 41/42     |
| Mechanism                    | Motorized |

### Controlled by:



access control system;



manual control

When power goes OFF both directions are free.

### Electrical Specifications:

- Voltage:
  - from the AC (100-240)V, 50/60Hz;
  - from a DC source 12 V;
- Maximum power consumption 55W per pass;

GATE-TS 650

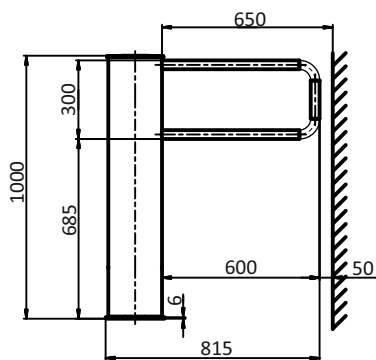

GATE-TS 900  
for disabled and trolley access

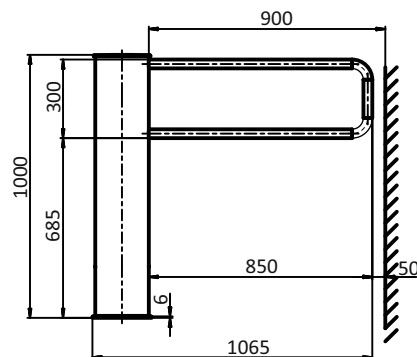

### Materials

|                   |  |
|-------------------|--|
| Standard housing  | Brushed SS AISI 304  |
| Available housing | Brushed SS AISI 316<br>Polished SS AISI 304<br>Polished SS AISI 316<br>Powder coated RAL |

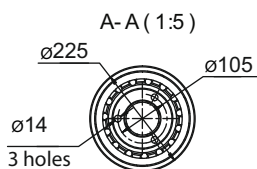
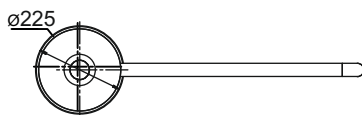

### Installation areas:

- Governmental Institutions
- Military Bases
- Nuclear Power Plants
- Production sites (Industrial Plants)
- Commercial areas
- Financial institutions
- Airport Premises
- Business (Office) Centers
- Hotels
- Sport Complexes
- Recreation areas
- Urban areas
- Education Institutions
- others

